

Thames Art Gallery - Exhibition Floor Plans

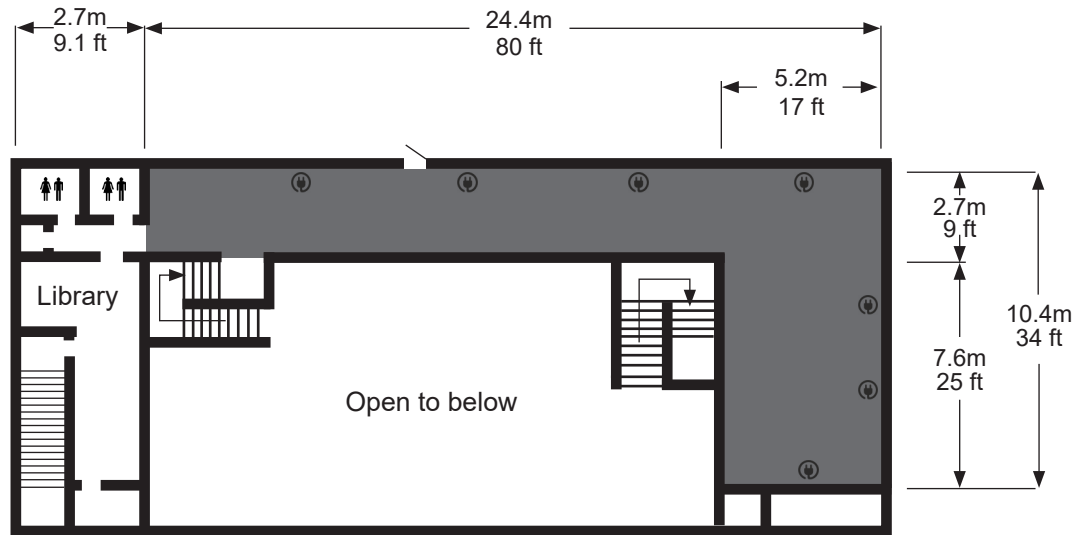

Mezzanine Exhibition Area

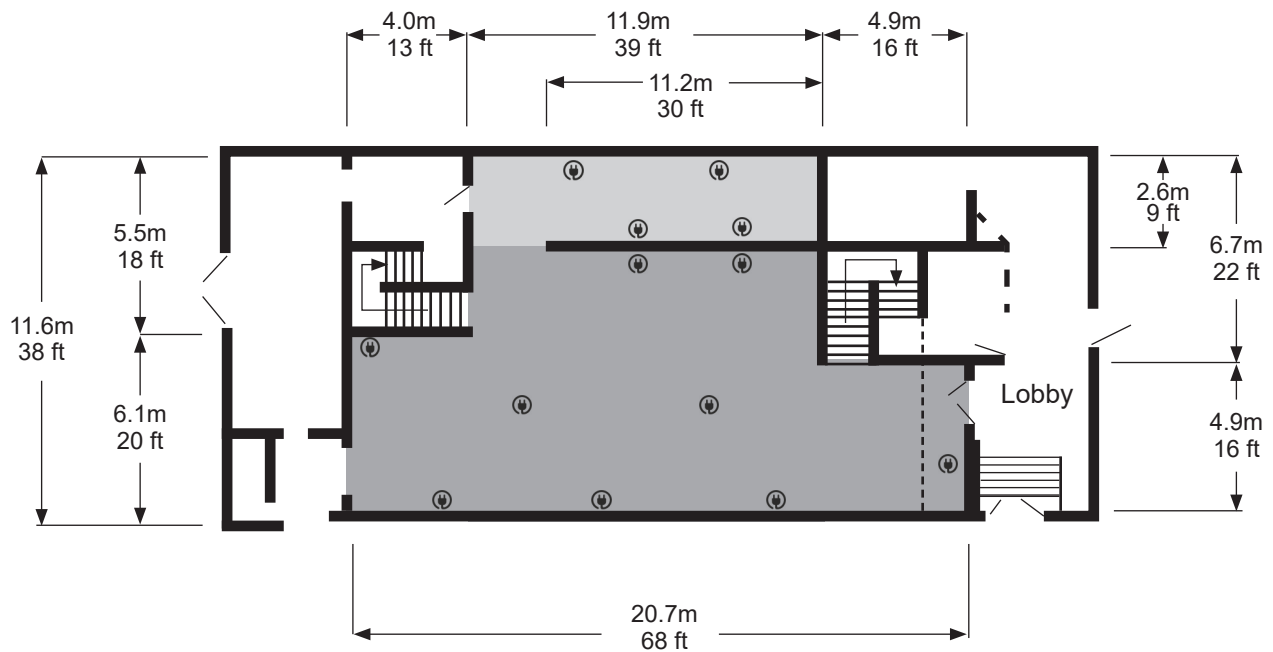

Ground Floor Exhibition Area

- Ground Floor Gallery Area**
 2000 square feet or 187 square metres, 200 running feet. Hardwood floors. 16 feet or 3 metres high ceilings (except under Mezzanine). Total floor area: 3200 square feet or 300 square metres.
- Project Room Area**
 313.4 square feet or 29.1 square metres. Hardwood floors. 8 feet or 2.44 metres high ceilings
- Mezzanine Gallery Area**
 1200 square feet or 113 square metres, 120 running feet. Tile floors. 8 feet or 2.44 metres high ceilings